

ASSEMBLY INSTRUCTIONS FOR

Refrigerator Shelf or Box Locking System (#18629)

Make sure the mounting surface is clean and dry before you attach the Acrylic Pads.



Step 1. Peel the protective backing from the adhesive backed Acrylic Pads.



Step 2. Align the Acrylic Pad on the inside of the refrigerator and press firmly to attach.



Step 3. Align the Acrylic Pad on the side of the lock box and press firmly to attach.



Call Free 1.800.848.1633 • Fax Free 1.800.447.2923
Web: GoHCL.com • Email: hcl@GoHCL.com

ASSEMBLY INSTRUCTIONS FOR

Refrigerator Shelf or Box Locking System (#18629)

Make sure the mounting surface is clean and dry before you attach the Acrylic Pads.



Step 1. Peel the protective backing from the adhesive backed Acrylic Pads.



Step 2. Thread an Acrylic Pad thru the wire shelving at the back of the refrigerator.



Step 3. Align the top Acrylic Pad on the back wall of the refrigerator and press firmly to attach.



Step 4. Align the bottom Acrylic Pad on the back wall of the refrigerator and press firmly to attach.



Call Free 1.800.848.1633 • Fax Free 1.800.447.2923
Web: GoHCL.com • Email: hcl@GoHCL.com

ASSEMBLY INSTRUCTIONS FOR

Refrigerator Shelf or Box Locking System (#18629)

Make sure the mounting surface is clean and dry before you attach the Acrylic Pads.

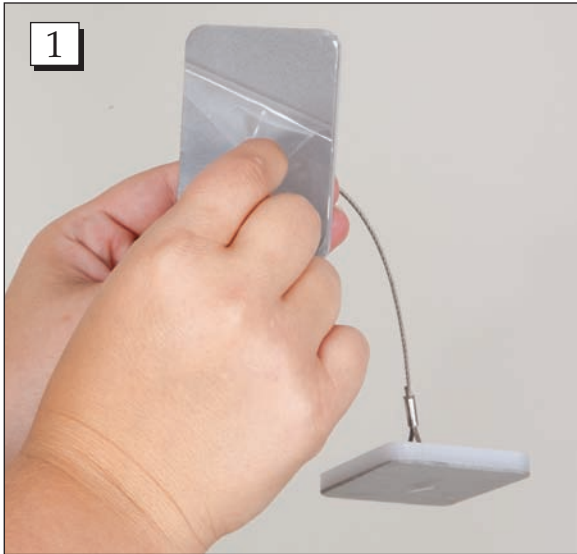

Step 1. Peel the protective backing from the adhesive backed Acrylic Pads.



Step 2. Align the Acrylic Pad on the inside of the refrigerator and press firmly to attach.

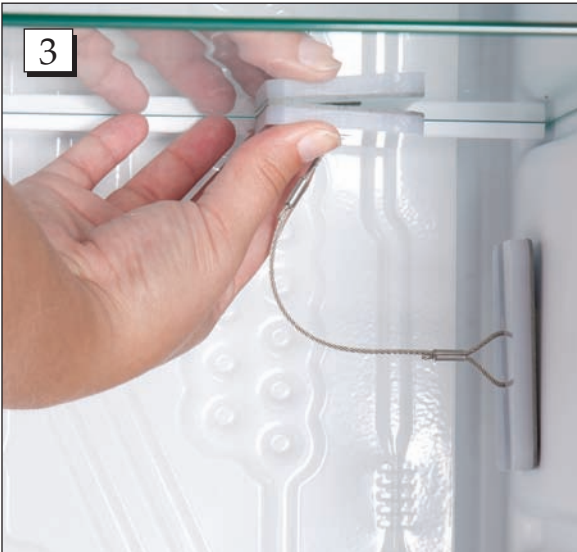

Step 3. Align the Acrylic Pad on the underside of the glass shelf and press firmly to attach.



Call Free 1.800.848.1633 • Fax Free 1.800.447.2923
Web: GoHCL.com • Email: hcl@GoHCL.com